

TOTAL AREA STATEMENT		
S.NO.	PARTICULARS	AREA (SQ. MT.)
1.	TOTAL LAND AREA	2,21,766.00
2.	AREA UNDER ROAD WIDENING	3477.74
3.	A. 30 MT. WIDE GREEN BELT ALONG RAILWAY LINE = 15241.21	50686.63
	B. 30 MT. WIDE GREEN BELT ALONG NH-24 = 16287.81 SQ. MT.	
	C. 25 MT. WIDE GREEN BELT ALONG PROPOSED 45 MT. ROAD = 10186.76 SQ. MT.	
	D. AREA AFTER 25 MT. GREEN BELT TOWARDS PREET VIHAR = 8970.85 SQ. MT.	
4.	NET AREA = 1-(2+3)	167601.63
5.	GREEN / OPEN AREA	13982.47 (8.34%)
6.	RESIDENTIAL POCKET FOR FARMERS	
	TOTAL AREA = 16964.00 SQ. MT.	
	GREEN AREA REQUIRED FOR RESIDENTIAL POCKET = 15% (8.34 + 6.66) = 1129.80 SQ. MT. (6.66%)	
7.	TOTAL GREEN / OPEN AREA = (A+B+C+D)	55698.25

(TABLE NO.1) AREA STATEMENT OF GODOWN PLOTS.			
S.NO.	PARTICULARS	NO. OF PLOTS	AREA (SQ. MT.)
1.	TOTAL GODOWN AREA		44125.46
	GODOWN TYPE - A	35	5446.21
	GODOWN TYPE - B	01	632.97
	GODOWN TYPE - C	06	3623.88
	GODOWN TYPE - D	52	17848.36
	GODOWN TYPE - E	04	2945.04
	TOTAL GODOWN AREA	98	30496.46
2.	TOTAL BOOKING AREA	326	13629.00

(TABLE NO.2) AREA STATEMENT OF COMMERCIAL PLOTS		
S.NO.	PARTICULARS	AREA (SQ. MT.)
1.	TOTAL COMMERCIAL AREA	18193.38
A.	COMMERCIAL AREA - 01	1095.93
B.	HOTEL	2246.75
C.	OFFICES	3678.86
D.	FUEL FILLING STATION - 01	990.00
E.	FUEL FILLING STATION - 02	594.00
F.	RESTAURANT - 01	516.28
G.	RESTAURANT - 02	516.85
H.	RESTAURANT - 03	500.00
I.	RESTAURANT - 04	512.55
J.	SERVICE STATION	647.85
K.	WEIGHING BRIDGE - 01	800.07
L.	WEIGHING BRIDGE - 02	1365.00
M.	COMMERCIAL AREA OF ALL SHOPS	4391.44
N.	DOMESTORY	600.00
O.	COMMERCIAL AREA - 02	366.18
	TOTAL COMMERCIAL AREA	18193.38

(TABLE NO.3) TOTAL FACILITY AREA		
S.NO.	PARTICULARS	AREA (SQ. MT.)
A.	POLICE CHECK POST	199.97
B.	E.S.S.	2724.22
C.	PUBLIC TOILETS	336.10
	TOTAL FACILITY AREA	3227.29

(TABLE NO.4) DETAILS OF RESIDENTIAL PLOTS			
S.NO.	PLOT SIZE	AREA	NO. OF PLOTS
1.	04.00 x 07.50	30.00	21
	05.00 x 12.00	60.00	14
	07.50 x 15.00	112.50	15
	10.00 x 20.00	200.00	29
	TOTAL		79

(TABLE NO.4) TOTAL PARKING AREA		
PARTICULARS	AREA (SQ. MT.)	TOTAL
A. AREA FOR TRUCKS (25 X 32)	800.00	
B. AREA FOR CAR PARKING (132 X 13.75)	1815.00	
TOTAL PARKING AREA	2615.00	2615.00

AREA STATEMENT TYPE - A GODOWN				
S.No.	GODOWN NO.	DIMENSION (IN METER)	PLOT AREA (SQ.MT.)	TOTAL AREA (SQ.MT.)
01	92	-----	116.50	116.50
02	93	-----	112.16	112.16
03	94	-----	117.43	117.43
04	95	-----	122.71	122.71
05	96	-----	127.98	127.98
06	97	-----	133.26	133.26
07	98	-----	138.53	138.53
08	99	-----	143.81	143.81
09	100	-----	149.08	149.08
10	101	-----	154.36	154.36
11	102	-----	159.63	159.63
12	103	-----	164.91	164.91
13	104	-----	170.18	170.18
14	105	-----	175.46	175.46
15	106	-----	180.73	180.73
16	107	-----	186.01	186.01
17	108	-----	191.28	191.28
18	109	-----	196.56	196.56
19	110	-----	201.83	201.83
20	111 & 126	13.46 X 15.00	201.90	403.80
21	112 to 125	10.00 X 15.00	150.00	2100.00
	TOTAL GODOWN AREA		35	5446.21

AREA STATEMENT TYPE - B GODOWN				
S.No.	GODOWN NO.	DIMENSION (IN METER)	PLOT AREA (SQ.MT.)	TOTAL AREA (SQ.MT.)
1	69	16.23 X 39.00	632.97	632.97
	TOTAL GODOWN AREA		1	632.97

AREA STATEMENT TYPE - C GODOWN				
S.No.	GODOWN NO.	DIMENSION (IN METER)	PLOT AREA (SQ.MT.)	TOTAL AREA (SQ.MT.)
1	76 to 78	16.23 X 37.21	603.98	1811.94
2	79 to 81	16.23 X 37.21	603.98	1811.94
	TOTAL GODOWN AREA		6	3623.88

AREA STATEMENT TYPE - D GODOWN				
S.No.	GODOWN NO.	DIMENSION (IN METER)	PLOT AREA (SQ.MT.)	TOTAL AREA (SQ.MT.)
1	1 & 12A	16.46 X 26.18	431.01	862.01
2	2 to 12	12.50 X 26.18	327.25	3600.08
3	14 & 26	16.46 X 26.18	431.01	862.01
4	15 to 25	12.50 X 26.18	327.25	3600.08
5	27 & 39	16.46 X 26.18	431.01	862.01
6	28 to 38	12.50 X 26.18	327.25	3600.08
7	40 & 52	16.46 X 26.18	431.01	862.01
8	41 to 51	12.50 X 26.18	327.25	3600.08
	TOTAL GODOWN AREA		52	17848.36

AREA STATEMENT TYPE - E GODOWN				
S.No.	GODOWN NO.	DIMENSION (IN METER)	PLOT AREA (SQ.MT.)	TOTAL AREA (SQ.MT.)
1	88	-----	701.58	701.58
2	89	-----	724.70	724.70
3	90	-----	747.82	747.82
4	91	-----	770.94	770.94
	TOTAL GODOWN AREA		04	2945.04

AREA STATEMENT BOOKING OFFICE - 1				
S.No.	BOOKING NO.	DIMENSION (IN METER)	PLOT AREA (SQ.MT.)	TOTAL AREA (SQ.MT.)
1	01	2.91X5	14.55	14.55
2	02 to 39	4.0X5.0	20.00	760.00
3	40	5.38X5.0	26.90	26.90
4	41	5.1X7.0	35.70	35.70
5	42 to 81	3.6X7.0	25.20	1008.00
6	82	-----	62.77	62.77
7	83	-----	77.83	77.83
8	84 to 125	3.6X9.0	32.40	1368.00
9	126	5.1X9.0	45.90	45.90
10	127 & 146	9.0X4.51	40.59	81.18
11	128 to 145	3.7X9.0	33.30	599.40
12	147 & 166	9.0X4.51	40.59	81.18
13	148 to 165	3.7X9.0	33.30	599.40
14	167 to 173	3.75X7.0	26.25	183.75
15	174	12.75X7.0	89.25	89.25
16	175 to 201	3.5X9.0	31.50	850.50
17	202	12.12X9.0	109.06	109.06
18	203 to 210	3.75X7.0	26.25	210.00
19	211 to 239	3.5X9.0	31.50	913.50
20	240	12.12X9.0	109.06	109.06
21	241 to 248	3.75X7.0	26.25	210.00
22	249 & 274	4.11X9.0	36.99	73.98
23	250 to 273	3.6X9.0	32.40	777.60
24	275 & 300	4.11X9.0	36.99	73.98
25	276 to 299	3.6X9.0	32.40	777.60
	TOTAL BOOKING OFFICE AREA		300	9131.89

AREA STATEMENT BOOKING OFFICE - 2				
S.No.	BOOKING NO.	DIMENSION (IN METER)	PLOT AREA (SQ.MT.)	TOTAL AREA (SQ.MT.)
1	301 & 318	5.21X8.0	41.68	83.36
2	302 to 317	4.0X8.0	32.00	512.00
3	319 & 336	6.69X9.21	61.61	123.22
4	320 to 335	4.0X9.21	36.84	589.44
5	337 & 354	6.69X9.21	61.61	123.22
6	338 to 353	4.0X9.21	36.84	589.44
7	355 & 372	6.69X8.0	53.52	107.04
8	356 to 371	4.0X8.0	32.00	512.00
9	373 & 390	6.69X8.0	53.52	107.04
10	374 to 389	4.0X8.0	32.00	512.00
11	391 & 408	6.69X8.0	53.52	107.04
12	392 to 407	4.0X8.0	32.00	512.00
13	409 & 426	6.69X8.0	53.52	107.04
14	410 to 425	4.0X8.0	32.00	512.00
15	427 to 436	4.0X9.0	36.00	360.00
	TOTAL BOOKING OFFICE AREA		136	4857.11

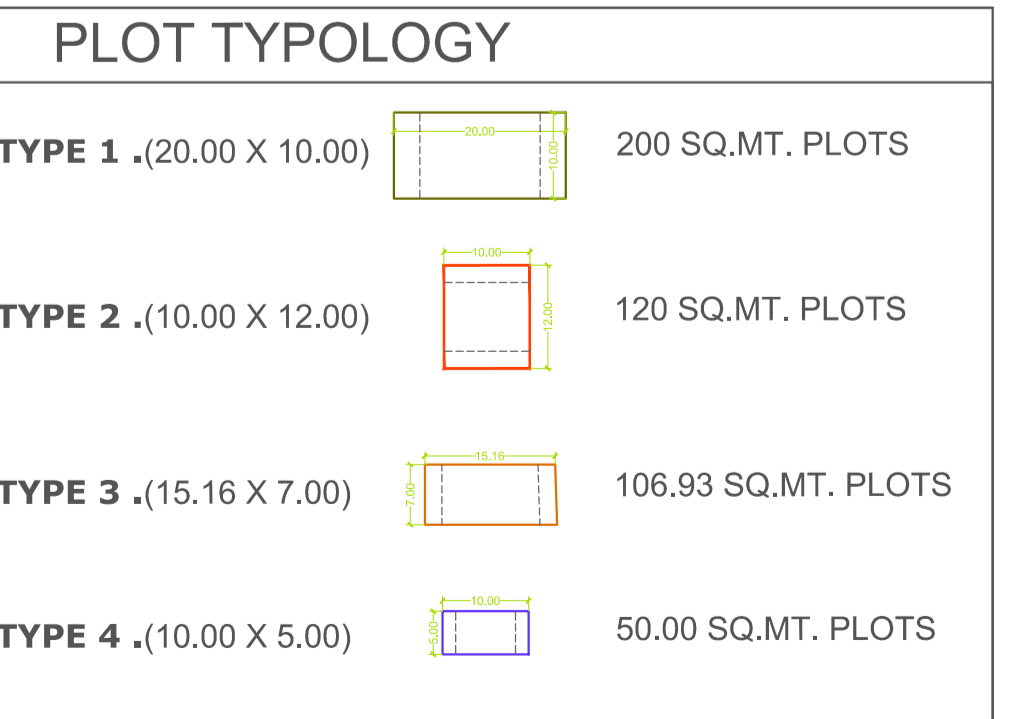

TOTAL PLOTTED AREA IN TRANSPORT NAGAR = (AREA OF TABLE NO.1 + AREA OF TABLE NO.2).
44125.46 + 18193.38 = 62318.84 SQ.MT

PROJECT-- LAYOUT PLAN 'TRANSPORT NAGAR' SITUATED AT VILLAGE ACHEJA, DELHI-HAPUR ROAD HAPUR, U.P.

CLIENT:- HAPUR PILKHWA DEVELOPMENT AUTHORITY

FOR APPROVAL --	
A.T.P.	EXECUTIVE ENGINEER
CHIEF ENGINEER	PRABHARI NIYOJAN
SECRETARY	VICE CHAIRMAN

IN RESIDENTIAL LAYOUT TOTAL NO. OF PLOT = 88